

LEGEND

- LANDS OWNERSHIP BOUNDARY
- SID APPLICATION SITE BOUNDARY
- PROPOSED DEVELOPMENT
- CONCURRENT PLANNING APPLICATION LODGED FOR DATA CENTRE UNDER PLANNING REF. SD21A/0241
- EXISTING WAYLEAVE
- PROPOSED UNDER GROUND GRID ROUTE
- PROPOSED JOINT BOX
- HV DUCTING FOR FUTURE CONNECTION

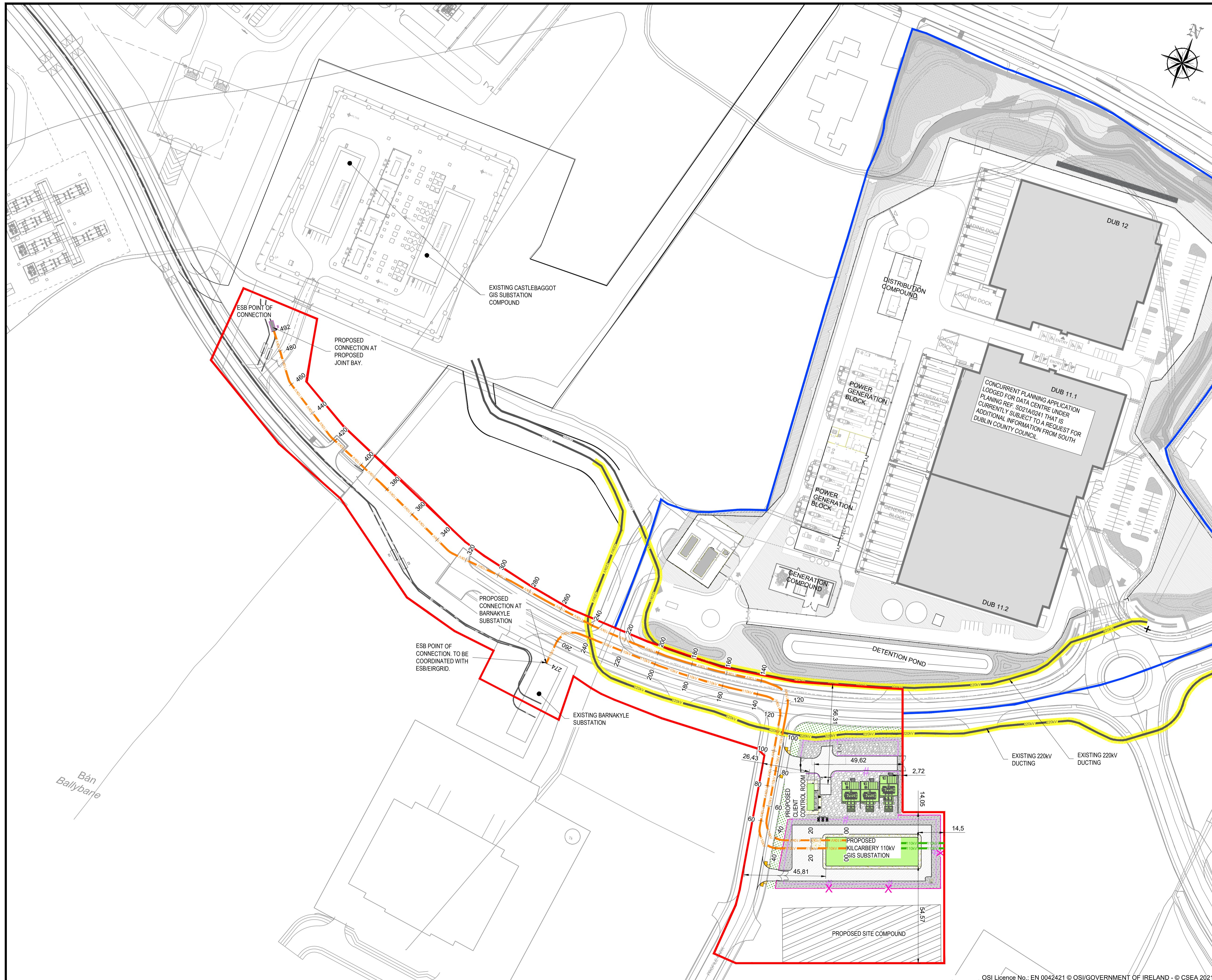

P04	SID ISSUE	DM	PM	04.02.2022
P03	DRAFT SID ISSUE	DM	PM	10.12.2021
P02	SID SCHEME ISSUE	DM	PM	26.11.2021
P01	WIP	DM	PM	22.10.2021
Rev	Description	Drawn	Checked	Date

Clifton Scannell Emerson Associates
Clifton Scannell Emerson Associates Limited
 Consulting Engineers,
 3rd Floor The Highline,
 Bakers Point, Pottery Road,
 Dun Laoghaire, Co. Dublin,
 Ireland, A96 KW29

T: +353 1 288 5006
 F: +353 1 283 3466
 E: info@csea.ie
 W: www.csea.ie

VANTAGE DATA CENTERS	
Client	
KILCARBERRY 110KV SUBSTATION & MV CLIENT COMPOUND	
Project	
PROPOSED OVERALL SITE LAYOUT PLAN	
Dwg. Title	
Drawn By	Date
DM	OCT 2021
Checked By	Scale
PM	1:1000 @ A1
CSEA Job No.	
21_115	
Project Code	Originator
Zone/Phase	Level
Type	Role
Dwg. No.	
21_115 - CSE - 00 - XX - DR - C - 1200	
Status Code	Suitability Description
S2	PRELIMINARY
P04	PRELIMINARY
Revision	Project Status